

Accramax™ Quick-Change Mandrel Performance Testimonials from the Field

When we installed the prototype of the new AccraMax mandrel almost 5 years ago, the circular saw world changed for us!

#1 We haven't had a claim on mis-cut lumber since (even in frozen Hard Maple & Hickory).

#2 Production went up due to higher feed speeds and straighter cuts.

#3 We change our wear plates every 4 to 6 months and eliminate any and all down time. (This mandrel has saved us thousands of dollars).

-Pennyrile Sawmill

The AccraMax Mandrel has made a big difference in our production. Our saw no longer wobbles but stands up straight. We have tripled our saw life between hammer jobs. We have faster feed speeds while still maintaining a uniform product. And best of all, in 10 minutes or less, we can have new sawing tolerances with the AccraMax, instead of a multi-day task with OEM Mandrel.

-Lakeside Log & Lumber

Ask us about our...



This program is designed from the perspective of the circular saw mill operator. It offers many benefits, cost savings, optimum accuracy, efficiency, convenience and peace of mind for circular sawmill operators.

SALES:

260.568.2534

MANUFACTURING:

260.589.2244

www.accramax.com

The logo features a stylized orange lightning bolt arching over the text 'AccraMax™' in a bold, sans-serif font. Below this, 'QUICK-CHANGE MANDREL' is written in a smaller, bold, sans-serif font. The entire logo is set against a dark, semi-circular background that resembles a saw blade.

AccraMax™
QUICK-CHANGE MANDREL

A REVOLUTION IN CIRCULAR SAWMILL PRODUCTION

Revolutionary Concept

Until now, options for re-machining the contact surface of standard mandrels have required either in-place machining with a mobile rig or the removal of the entire mandrel/shaft assembly to be sent to a machine shop. Both of these options are cumbersome, expensive and can involve multi-day downtime. This innovative product, features removable wear plates that can be changed out in 15 minutes or less, virtually eliminating downtime. The plates are then sent to be resurfaced.

Revolutionary Accuracy

Because of enormous task of resurfacing standard mandrels, proper machining tolerances are often overcorrected in a bid for more time between resurfacing incidents. Our plates are precision-machined for an ideal fit to the blade, resulting in much greater blade cut accuracy, longer blade life and faster feeding speeds. (One customer was able to put a blade back into production he could no longer run with his OEM mandrel.) This allows mandrel plates to be changed more often for high product consistency instead of waiting until quality is intolerable.

Revolutionary Backup Plan

Surprises no longer need to destroy your production. An extra set of plates in inventory will essentially eliminate downtime, in many cases, even in the face of an unfortunate sawmill 'wreck'.

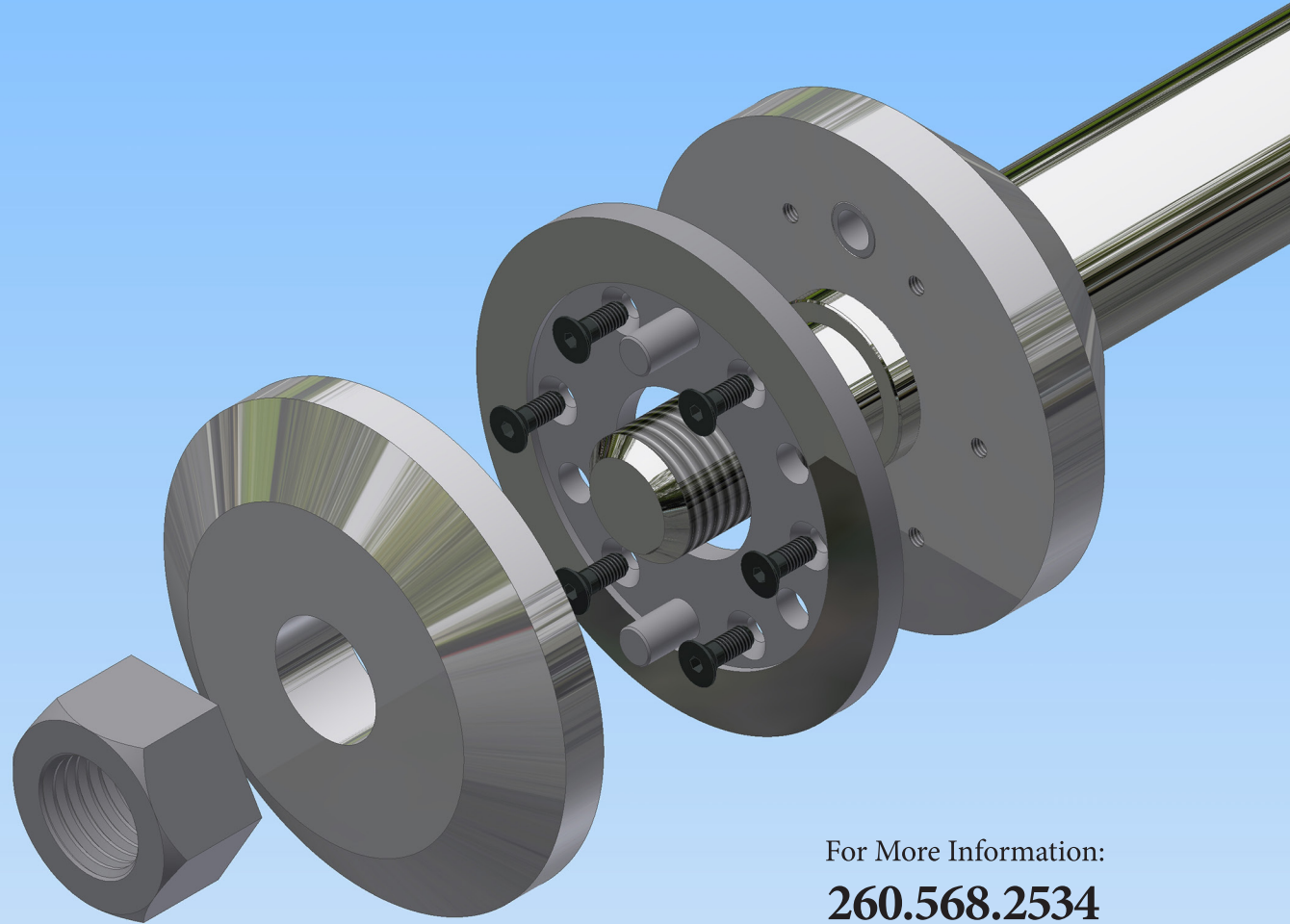

For More Information:
260.568.2534
www.accramax.com

Replacing mandrel contact surface plates is quick and easy...all done in less than 10 minutes!



1. Loosen the nut



2. Remove outer plate and saw blade



3. Remove bolts in inner plate



4. Remove inner plate



5. Slide on new inner plate



6. Tighten inner plate



7. Install guide pins, blade, new outer plate & nut.